

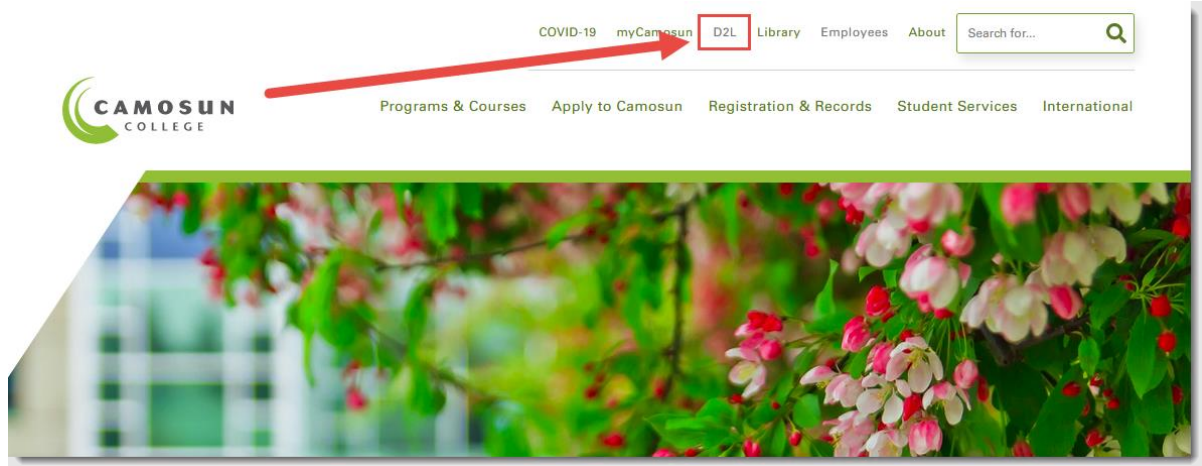

Logging into D2L – a Student Tutorial

1. Open an Internet browser and go to the Camosun College website (<http://camosun.ca>). We recommend you use Chrome as your Internet browser if possible. Then click **D2L** in the top navigation bar. (If your screen is small, you may need to click on the hamburger menu – three line menu – at the top right and scroll down to select D2L.)



2. Type in your Camosun ID number (your C#) and the Password you use with your C# to log into college computers. Then click **Log in**.

NOTE: IF you do not have a password for your C# yet, or if you have forgotten your password, you will have to go to <http://password.camosun.ca>, login, and click **Forgot Password**. If you are unable to reset your password, submit [a help ticket](#) or call 250-370-3064.



- Once you have logged into D2L, you will see the courses you have access to listed in the **My Courses** box on the homepage. Click on the title of the course you wish to access to go to it. *Note that you will NOT be able to access your D2L course site until the start date of the course.*

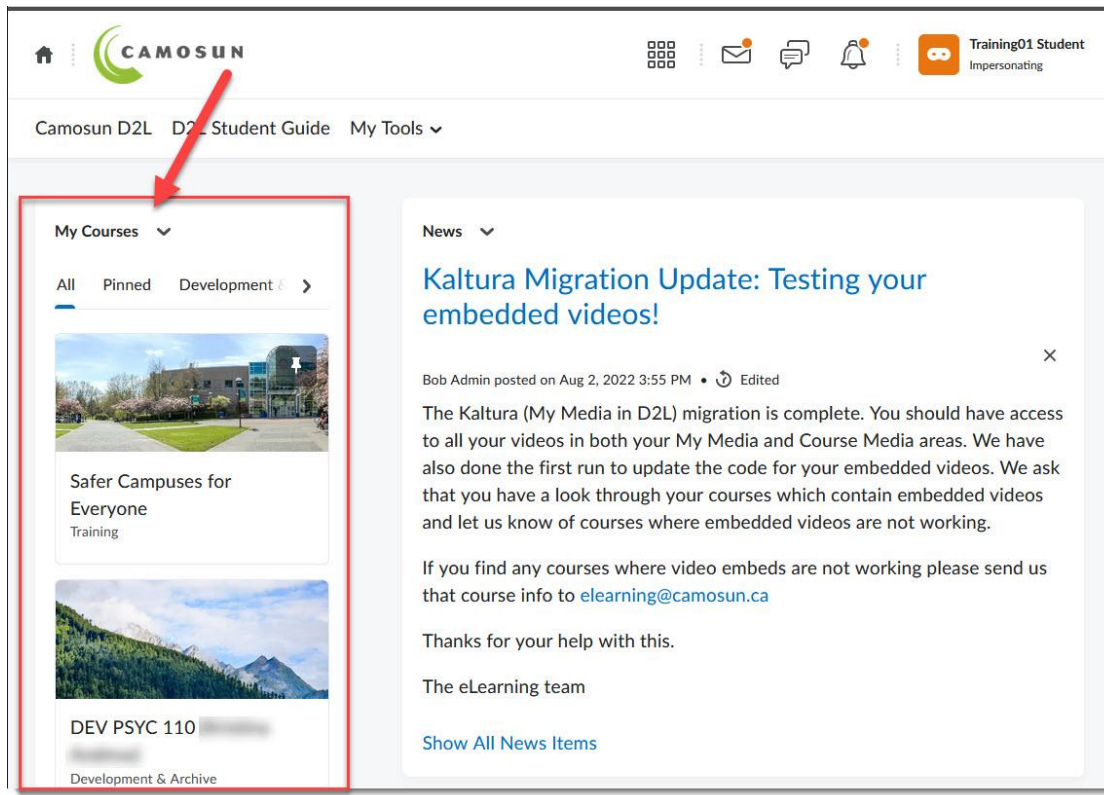

You may wonder where you will find your course content in your course site. This will vary from course to course, depending on your instructors. Some places to look include:

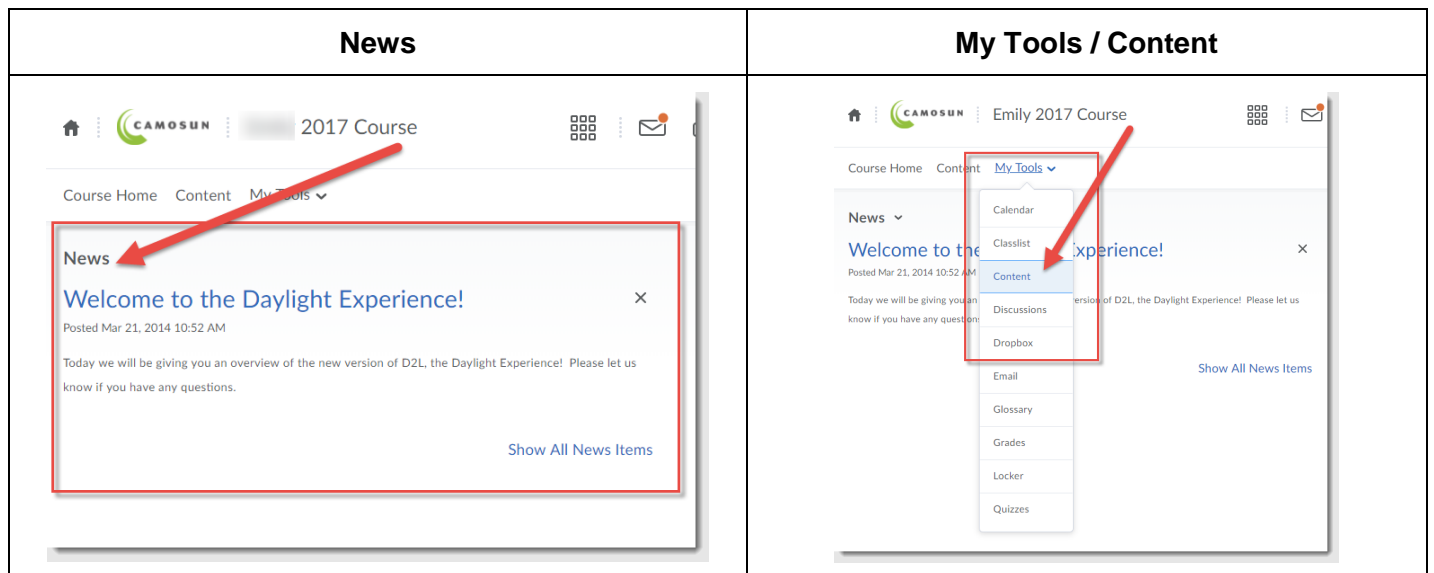

If you still don't know where to find your course materials, talk to your instructor!

Finally, if you have technical issues with D2L during the term, go to our [Team Dynamix Support portal](#) and click the appropriate Category to submit a ticket.



This content is licensed under a [Creative Commons Attribution 4.0 International Licence](#). Icons by the [Noun Project](#).